

**CITY OF PORTSMOUTH
LEGAL DEPARTMENT
MEMORANDUM**

DATE: April 17, 2017
TO: RICK TAINTOR, PLANNING DIRECTOR
FROM: SUZANNE M. WOODLAND, DEPUTY CITY ATTORNEY
RE: 240 MRYTLE AVENUE & 260 MRYTLE AVENUE

The Department of Public Works is preparing this spring to relocate a portion of public sewer main which currently crosses two residential properties at 240 Myrtle Avenue and 260 Myrtle Avenue. The Department of Public Works plans to relocate an older sewer line from underneath the residential home at 240 Myrtle Avenue to the driveway of that property. See the attached plan showing the existing location of the sewer line as well as the proposed location of the relocated line. The property owners of 240 Myrtle Avenue, Charles Schulte and Katherine Cahill, are prepared to execute a temporary construction and permanent easement deed for the newly located line.

In addition, the property owner for 260 Myrtle Street, David Lear, is also prepared to execute a permanent sewer line easement deed once a survey is complete as it has come to the attention of the City that no recorded easement deed for that portion of the sewer line which extends across 260 Myrtle exists. No relocation of the sewer line or other work will be taking place on 260 Myrtle Street.

City staff recommends acceptance of a sewer line easement for each property

PROPOSED MOTION: That the Planning Board move to recommend the City Council accept a sewer line easement from Charles Schlutz and Katherine Cahill of 240 Myrtle Avenue and from David Lear of 260 Myrtle Avenue.

attachments

cc: Ray Pezzullo, Asst. City Engineer
Terry Desmarais, Jr., City Engineer

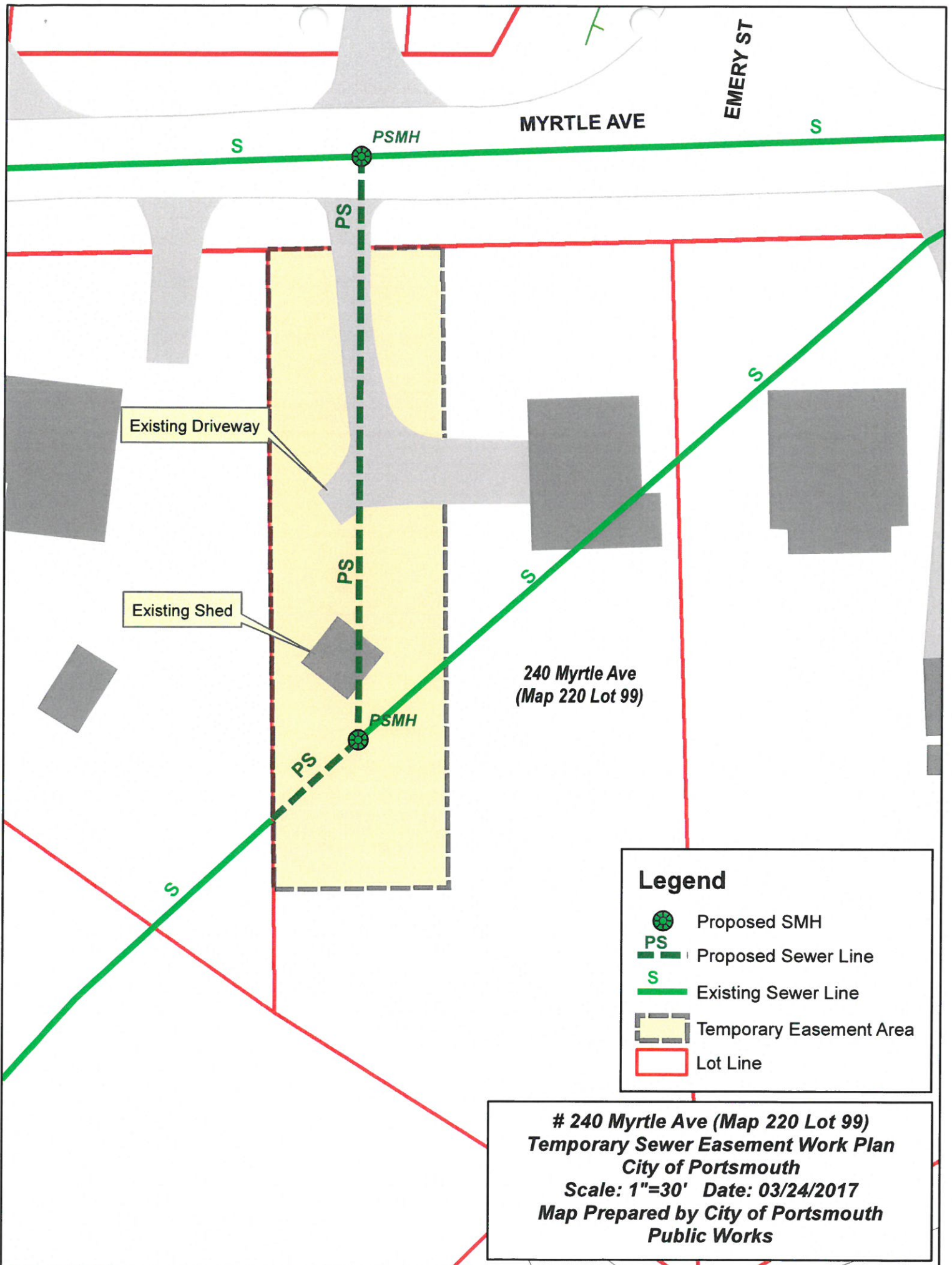





Existing Driveway

Existing Shed

240 Myrtle Ave
(Map 220 Lot 99)

Legend

-  Proposed SMH
-  Proposed Sewer Line
-  Existing Sewer Line
-  Temporary Easement Area
-  Lot Line

**# 240 Myrtle Ave (Map 220 Lot 99)
Temporary Sewer Easement Work Plan
City of Portsmouth
Scale: 1"=30' Date: 03/24/2017
Map Prepared by City of Portsmouth
Public Works**

PROPOSED SEWER EASEMENT #260 MYRTLE AVE

