

299 VAUGHAN STREET PORTSMOUTH, NEW HAMPSHIRE



WATERFRONT PARK COMMUNITY SPACE EXHIBIT

COMMUNITY SPACE TABLE:

PROJECT AREA COMMUNITY SPACE = 30% OF PROJECT AREA (55,343 SF x 30%)
 *DOES NOT INCLUDE 28,906 SF PARCEL B: FUTURE COMMUNITY SPACE

	REQUIRED	PROVIDED
PROJECT AREA COMMUNITY SPACE = 30% OF PROJECT AREA (55,343 SF x 30%)	20,038 SF	20,038

COMMUNITY SPACE LEGEND:

	SIDEWALK COMMUNITY SPACE	2,433 SF
	WATERFRONT GATEWAY COMMUNITY SPACE	2,721 SF
	PARCEL A: PROJECT AREA COMMUNITY SPACE	14,884 SF
TOTAL COMMUNITY SPACE		20,038 SF

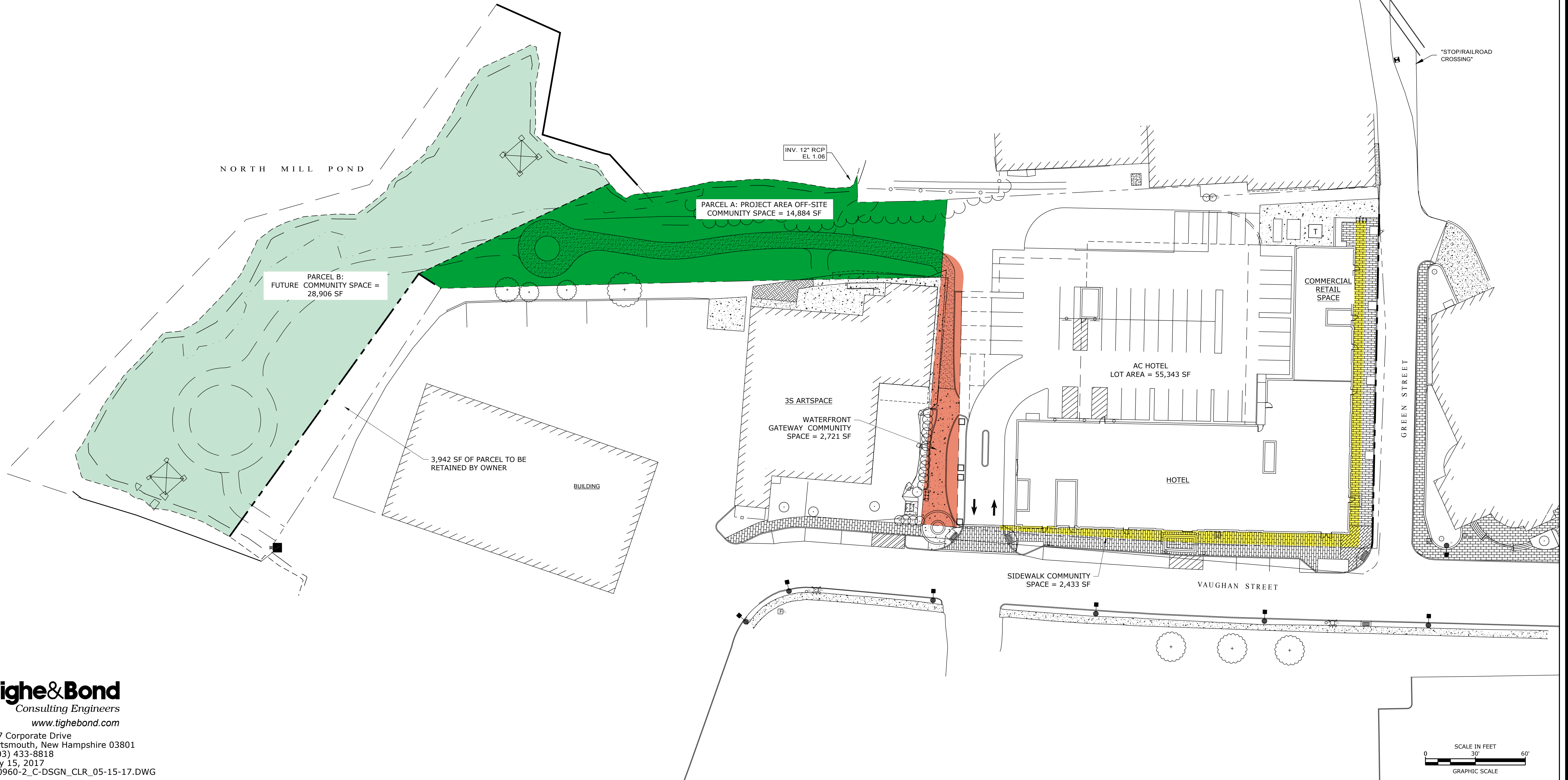
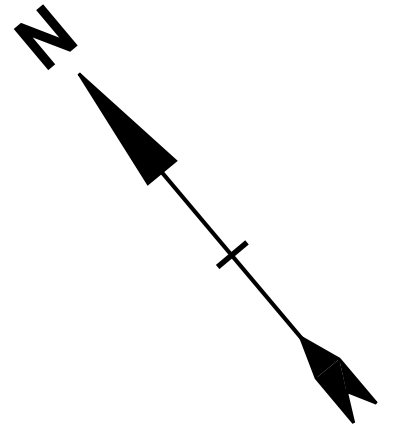

Tighe & Bond
 Consulting Engineers

www.tighebond.com
 177 Corporate Drive
 Portsmouth, New Hampshire 03801
 (603) 433-8818
 May 15, 2017
 C-0960-2_C-DSGN_CLR_05-15-17.DWG

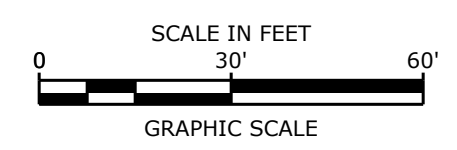

C-0960-2_C-DSGN_CLR_05-15-17.dwg Date Plotted: May 15, 2017 - 4:33pm Plotted By: NAHANSEN